

Ceiling Height: 9' 0" AFF
Flooring: VCT (Optional Anti-static Coating)
Lighting: Building Standard
Emergency Light Fixture: YES
Backboard: Fire Rated BB Plywood

- Dedicated 110 VAC 30 AMP LS-R Outlet Mounted Below the Plywood Backboard
- Dedicated 208 VAC 30 AMP L6-R Outlet Mounted Below the Plywood Backboard
- Non-Dedicated Quad 10VAC 15AMP Convenience Outlet Mounted Below the Plywood Backboard
- #6 Dedicated - Isolated Ground IG Bus in AC Panel

- Fire-rated plywood backboard
- Existing 4" Sleeve in Wall Above Ceiling
- Wall Phone Outlet

Customer Name: _____

Drawing Title: Equipment Room

Customer Contact: Ed Robles

Revision Date: August 28, 2003

Customer Address: 17645 West Bernardo, San Diego CA

Revision Number: 01

Scale: None



97 East Brokaw Road
 Suite 300
 San Jose, CA 95112
 P: (408) 436-8300
 F: (408) 436-1511
 www.alfatech.net

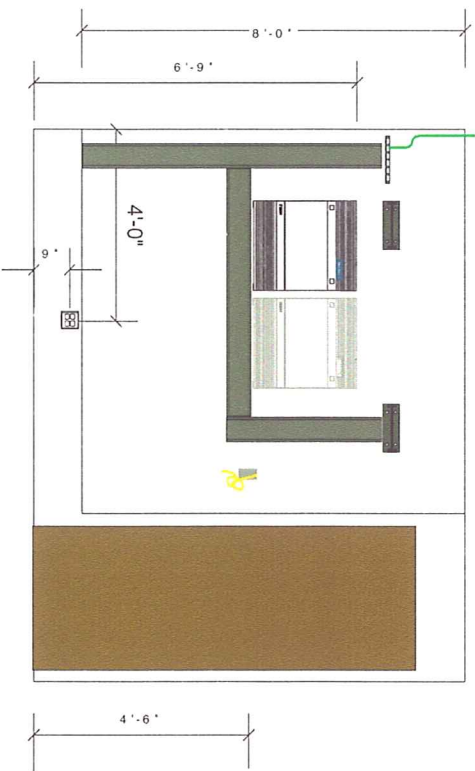

Ceiling Height: 9' 0" AFF
Flooring: VCT (Optional Anti-static Coating)
Lighting: Building Standard
Emergency Light Fixture: YES
Backboard: Fire Rated BB Plywood

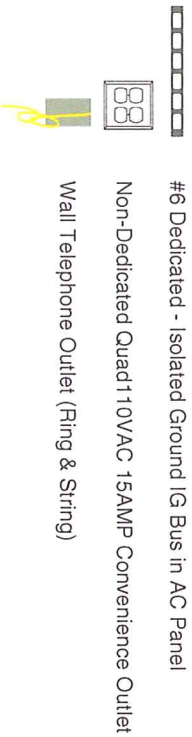

Customer Name:

Drawing Title: Equipment Room - Elevation 1

Customer Contact: Ed Robles

Revision Date: August 28, 2003

Customer Address: 16745 West Bernardo, San Diego, CA

Revision Number: 01

Scale: None



97 East Brokaw Road
 Suite 300
 San Jose, CA 95112
 P: (408) 436-8300
 F: (408) 436-1511
 www.alfatech.net

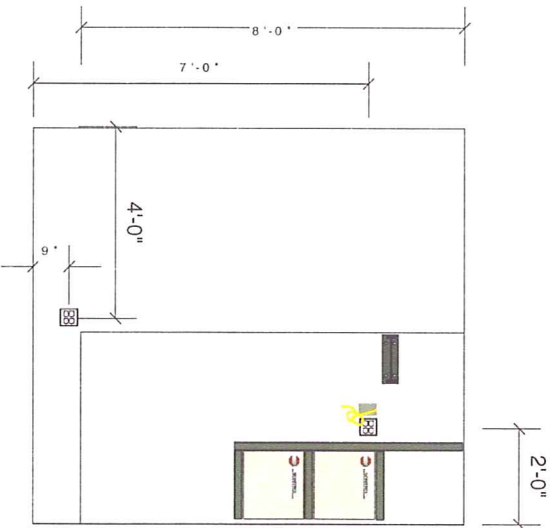

Ceiling Height: 9' 0" AFF
Flooring: VCT (Optional Anti-static Coating)
Lighting: Building Standard
Emergency Light Fixture: YES
Backboard: Fire Rated BB Plywood

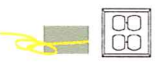

Non-Dedicated Quad 110VAC 15AMP Convenience Outlet
 Wall Telephone Outlet (Ring & String)



97 East Brokaw Road
 Suite 300
 San Jose, CA 95112
 P: (408) 436-8300
 F: (408) 436-1511
 www.alfatech.net

Customer Name:
Customer Contact: Ed Robles
Customer Address: 16745 West Bernardo, San Diego, CA

Drawing Title: Equipment Room - Elevation 2
Revision Date: August 28, 2003
Revision Number: 01
Scale: None

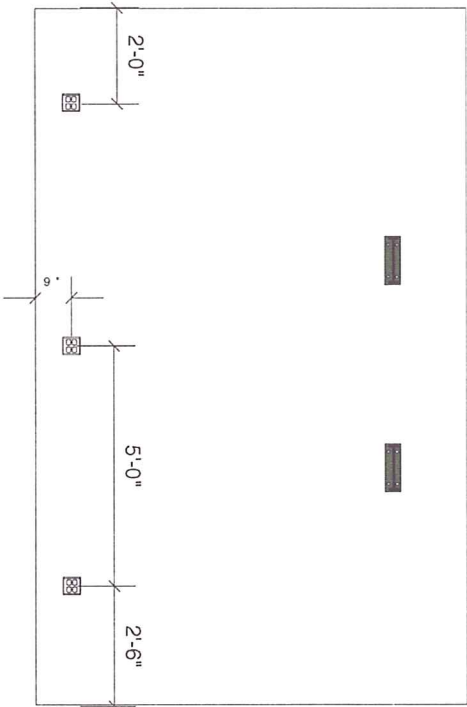

Ceiling Height: 9' 0" AFF
Flooring: VCT (Optional Anti-static Coating)
Lighting: Building Standard
Emergency Light Fixture: YES
Backboard: Fire Rated BB Plywood



Non-Dedicated Quad 110VAC 15AMP Convenience Outlet

Customer Name:

Customer Contact: Ed Robles

Customer Address: 16745 West Bernardo, San Diego, CA

Drawing Title: Equipment Room - Elevation 3

Revision Date: August 28, 2003

Revision Number: 01

Scale: None



97 East Brokaw Road
 Suite 300
 San Jose, CA 95112
 P: (408) 436-8300
 F: (408) 436-1511
 www.alfatech.net

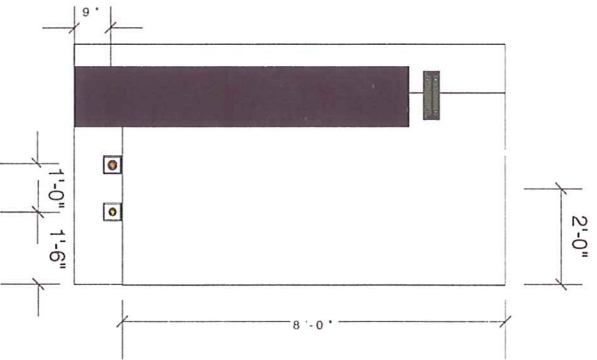

Ceiling Height: 9' 0" AFF
Flooring: VCT (Optional Anti-static Coating)
Lighting: Building Standard
Emergency Light Fixture: YES
Backboard: Fire Rated BB Plywood



Non-Dedicated Quad1 10VAC 15AMP Convenience Outlet
 Dedicated L6-R 30 AMP Receptacle
 Dedicated L5-R 30 AMP Receptacle

Customer Name:

Customer Contact: Ed Robles

Customer Address: 16745 West Bernardo, San Diego, CA

Drawing Title: Equipment Room - Elevation 4

Revision Date: August 28, 2003

Revision Number: 01

Scale: None



97 East Brokaw Road
 Suite 300
 San Jose, CA 95112
 P: (408) 436-8300
 F: (408) 436-1511
 www.alfatech.net